

# Context Sensitive Help

## Overview of User Assistance

User Assistance is an online help system. It is available directly from the application and independent from the application in a web browser. The User Assistance includes the complete contents of the User Guide. Additionally, it includes configuration information.

1. Once logged into cobas infinity, click on **F1** from anywhere in the **cobas<sup>®</sup> infinity** software. This will open the User Guide.
2. You also have the option to chose the  button on the Overview bar to access the same menu
3. The **Context** tab shows a list of topics that pertain to the screen you are currently viewing in cobas infinity
4. By selecting a topic on the left, the right will populate with detail about that topic
5. The **arrow buttons** at the top of the User Assistance window will allow you to move backwards or forward in browsing history topics

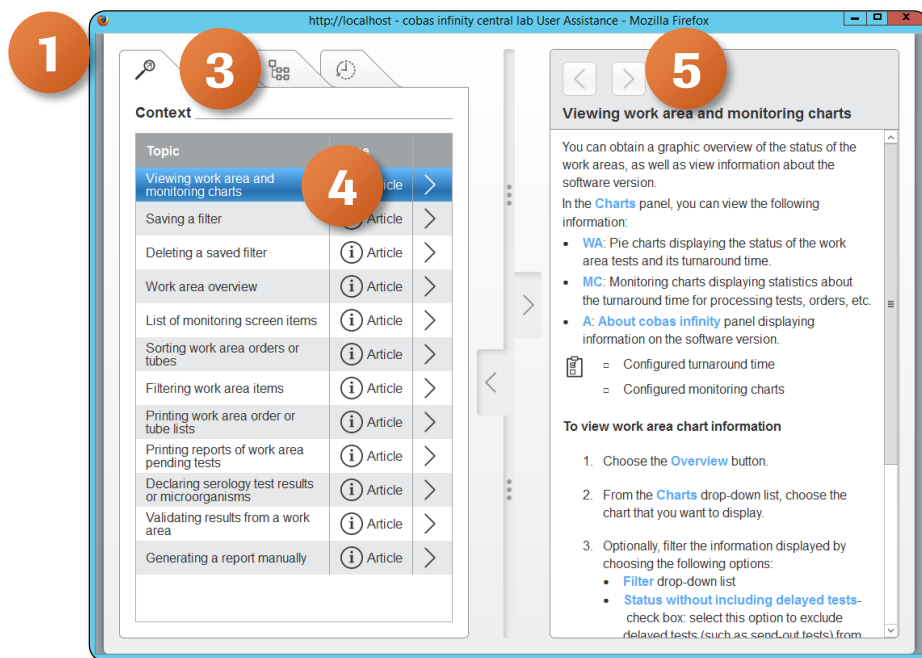

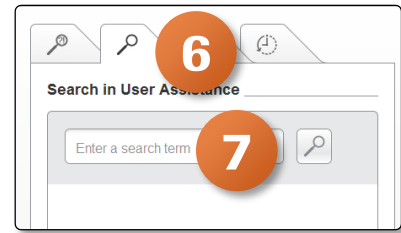

# Context Sensitive Help

- 6. The **Search** tab will allow you to search for topics
- 7. Type your search criteria in the field and click Enter or the  button

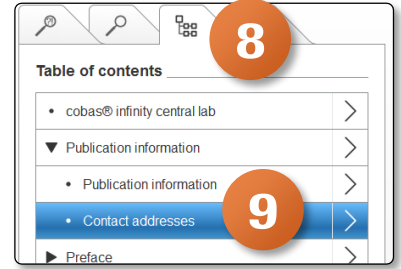

- 8. The **Table of contents** tab will give you visibility to a full table of contents
- 9. Choose the topic you wish to view from the list



- 10. The **Recently viewed** tab shows all topics that have been searched
- 11. Select a topic to view
- 12. The detail screen will show more information.
- 13. If an image is present in the detail screen, click on the  button to enlarge

